

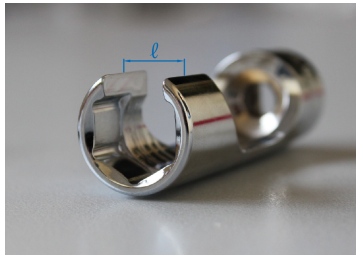

32H522S

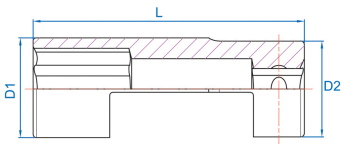

S Geopende lange dopsleutel inch 6-kantig 3/8"

- Inch
- Voor dieselmotor CUMMINS
- Geopende dop om de doorgang van een slang huls toestaan



	Afmetingen (Inch)	D1 (mm)	D2 (mm)	L (mm)	l (mm)	Gewicht (g)
32H522S	11/16"	25	24	81	13	111