

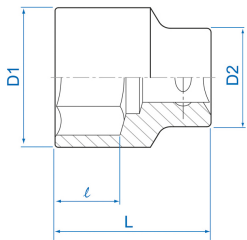

6330S



S Dopsleutel standaard inch 12-kantig 3/4"

ANSI / ASME B107.1

- Inch
- Vanadiumchroom, afwerking in gepolijst chroom

	Afmetingen (Inch)	D1 (mm)	D2 (mm)	L (mm)	l (mm)	Gewicht (g)
633022S	11/16"	26	36	52	14	195
633024S	3/4"	30	36	52	14	225
633026S	13/16"	32	36	52	16	228
633028S	7/8"	33	36	52	16	230
633030S	15/16"	35	36	52	16	240
633032S	1"	35	36	52	17	242
633034S	1-1/16"	38	36	52	19	238
633036S	1-1/8"	40	38	52	19	261
633038S	1-3/16"	42	38	54	21	295
633040S	1-1/4"	44	38	56	23	317
633042S	1-5/16"	46	40	56	23	351
633044S	1-3/8"	48	42	58	25	406
633046S	1-7/16"	50	42	58	25	434

**KING TONY***Enjoy your work*

633048S	1-1/2"	52	45	60	27	497
633050S	1-9/16"	54	45	62	28	537
633052S	1-5/8"	56	45	64	29	581
633054S	1-11/16"	58	45	65	29	591
633056S	1-3/4"	60	47	66	31	657
633058S	1-13/16"	62	47	68	34	724
633060S	1-7/8"	64	48	70	34	775
633062S	1-15/16"	66	48	70	34	832
633064S	2"	68	48	72	34	889
633066S	2-1/16"	70	50	74	35	950
633068S	2-1/8"	72	50	75	35	1020
633070S	2-3/16"	74	50	76	37	1120
633072S	2-1/4"	76	50	76	37	1120
633074S	2-5/16"	78	50	78	37	1160
633076S	2-3/8"	80	50	78	40	1240
633078S	2-7/16"	82	55	81	40	1366
633080S	2-1/2"	84	55	81	40	1460
633082S	2-9/16"	85	58	83	43	1510
633084S	2-5/8"	86	58	83	43	1510
633086S	2-11/16"	90	58	85	43	1555
633088S	2-3/4"	92	58	88	46	1865