

## 3535M



### **M** 3/8" Standard metric 6 points impact socket

DIN 3129

- em métrico
- Cromo molibdênio
- Acabamento em fosfato

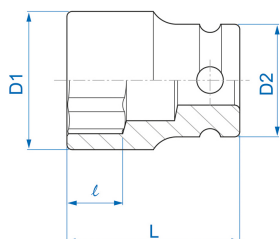

	Dimensão (mm)	D1 (mm)	D2 (mm)	L (mm)	l (mm)	Peso (g)
353506M	6	10,6	19	32	5	31
353507M	7	11,8	19	32	5	33
353508M	8	13,2	19	32	6	34
353509M	9	14,5	19	32	6	39
353510M	10	15,5	19	32	7	38
353511M	11	17,0	19	32	7	38
353512M	12	18,2	19	32	8	41
353513M	13	19,4	22	32	9	53
353514M	14	20,7	22	32	9	54
353515M	15	22,0	22	32	10	55
353516M	16	23,3	22	32	10	57
353517M	17	24,5	22	32	11	60
353518M	18	25,8	22	32	11	63



**KING TONY**

*Enjoy your work*

353519M

19

27,0

22

32

11

64