

4B55



M 1/2" 6 points standard metric impact socket with joint

DIN3121

- em métrico
- Perfeito para espaços de trabalho reduzidos
- Acabamento em fosfato
- Cromo molibdênio

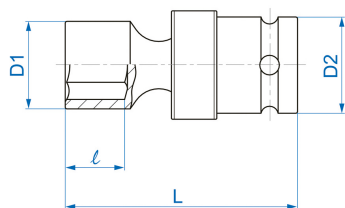

|  | Dimensão (mm) | D1 (mm) | D2 (mm) | L (mm) | l (mm) | Peso (g) |
|--|---------------|---------|---------|--------|--------|----------|
| 4B5510M | 10 | 17 | 27.5 | 64 | 12 | 161 |
| 4B5511M | 11 | 19 | 27.5 | 64 | 12 | 166 |
| 4B5512M | 12 | 19 | 27.5 | 64 | 12 | 162 |
| 4B5513M | 13 | 21.8 | 27.5 | 64 | 12 | 176 |
| 4B5514M | 14 | 22 | 27.5 | 64 | 12 | 174 |
| 4B5515M | 15 | 22 | 27.5 | 64 | 12 | 172 |
| 4B5516M | 16 | 23.9 | 27.5 | 64 | 12 | 180 |
| 4B5517M | 17 | 25 | 27.5 | 64 | 12 | 173 |
| 4B5521M | 21 | 30 | 27.5 | 64 | 12 | 190 |
| 4B5522M | 22 | 31.7 | 27.5 | 64 | 12 | 196 |