

## 6515M



**M** 6 points standard impact socket with thin square drive 3/4"

DIN 3121

- em métrico
- Acabamento em fosfato
- Cromo molibdênio

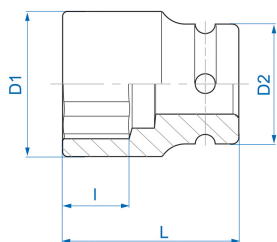

	Dimensão (mm)	D1 (mm)	D2 (mm)	L (mm)	l (mm)	Peso (g)
651514M	14	25	38	50	10	215
651515M	15	26	38	50	10	217
651516M	16	27.5	38	50	10	220
651517M	17	29	38	50	10	225
651518M	18	30	38	50	10	230
651519M	19	32	38	50	10	238
651521M	21	35	38	50	13	252
651522M	22	36	38	50	13	257
651523M	23	37	38	50	15	283
651524M	24	38	38	50	15	288
651525M	25	38	38	53	15	321
651526M	26	38	38	53	15	321
651527M	27	42	38	53	18	320



**KING TONY**

*Enjoy your work*

651528M	28	44	38	53	18	345
651529M	29	45	38	53	18	350
651530M	30	46	38	53	20	360