

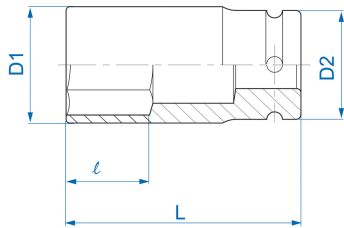

## 6935S



**S** 3/4" 6 points imperial thin wall long impact socket

ANSI / ASME B107.2

- Polegada
- Cromo molibdênio
- Acabamento em fosfato

	Dimensões (polegadas)	D1 (mm)	D2 (mm)	L (mm)	l (mm)	Peso (g)
693524S	3/4"	30	38	90	16	370
693530S	15/16"	36.5	38	90	23	415